

Spec-Brik (4" high nominal) Veneer
 Cold Forged Metal Frame
 16"x16" Anchor Spacing and 12" Max. HJR Spacing



Spec-Brik Veneer Details

Drawing No. 7002

REVISIONS		
MM/DD/YY	REVISIONS	REMARKS
1 12 /09 /19	Added Drawings	
2 -- /-- /--	...	
3 -- /-- /--	...	
4 -- /-- /--	...	
5 -- /-- /--	...	

01
 A

Veneer Anchor Spacing

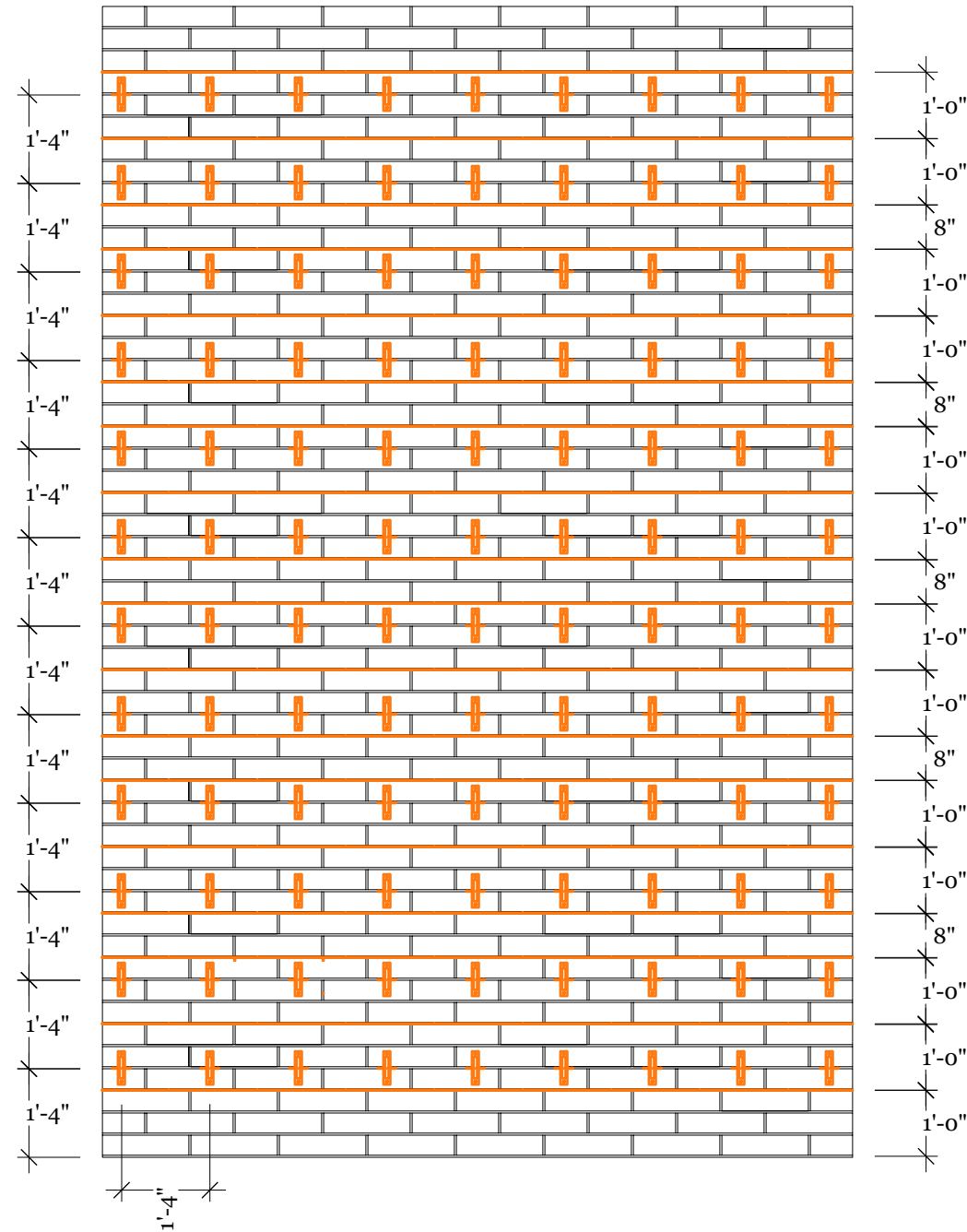

Horizontal Joint Reinforcement Spacing

Spacing adjusted to avoid placing HJR in Anchor courses.

Anchor Spacing: 16"x16"
Horizontal Joint Reinforcement Maximum Spacing: 12"



Spec-Brik Veneer Details

Drawing No. 7002

REVISIONS

	MM/DD/YY	REMARKS
1	12 / 09 / 19	Added Drawings
2	___/___/___	...
3	___/___/___	...
4	___/___/___	...
5	___/___/___	...

02

A

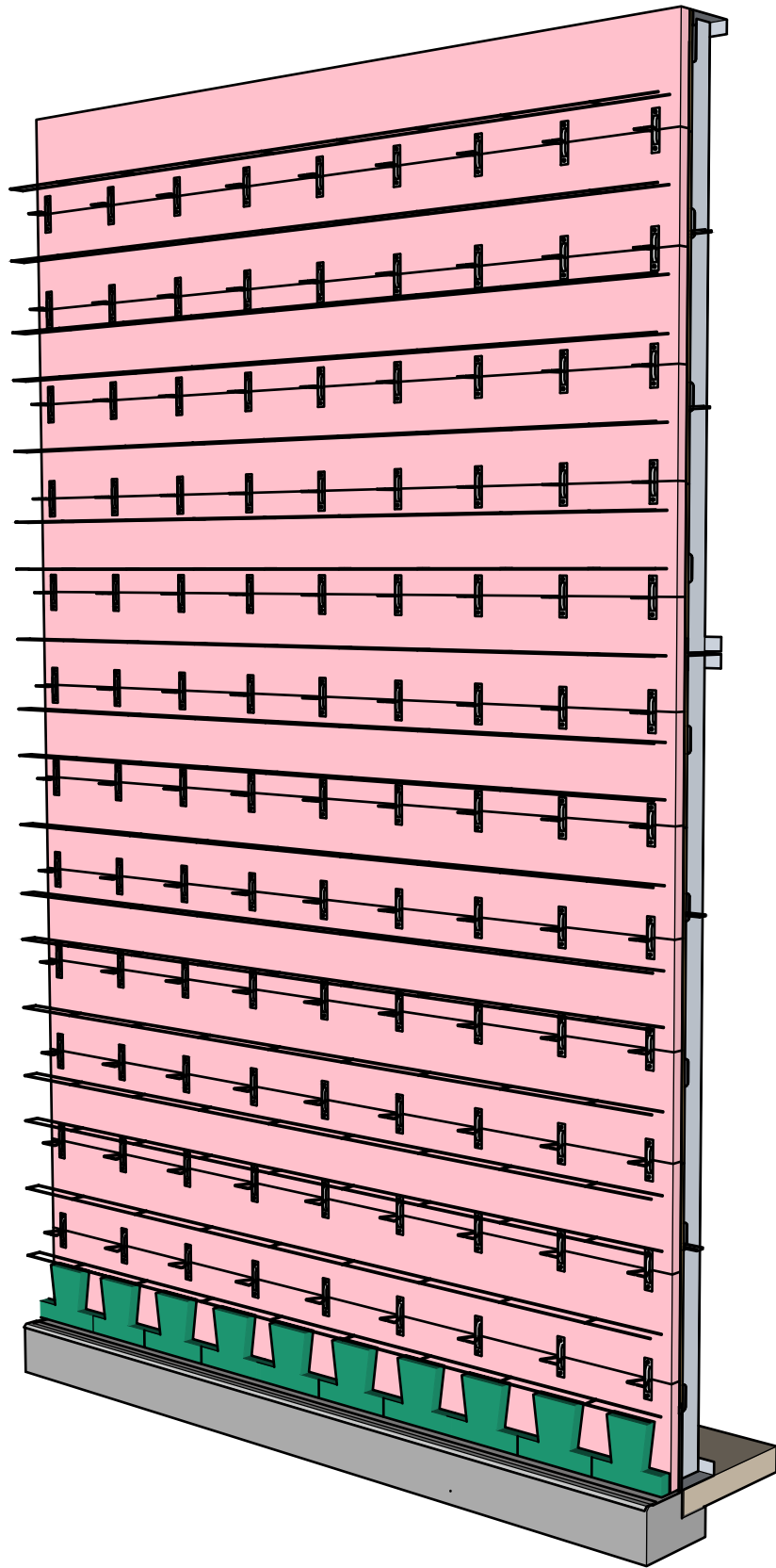

Perspective View of Anchor and HJR Placement
Wall Shown with Veneer Layer Hidden



Spec-Brik Veneer Details

Drawing No. 7002

REVISIONS		
MM/DD/YY	REVISIONS	REMARKS
1 12 /09 /19	Added Drawings	
2 --/--/--	...	
3 --/--/--	...	
4 --/--/--	...	
5 --/--/--	...	