

Spec-Brik Jumbo 8 high nominal  
 Cold Forged Metal Frame  
 Anchor Spacing: 24"vx16"h  
 HJR Spacing: Non-Anchored courses



Spec-Brik Veneer Details

Drawing No. 7006

REVISIONS		REMARKS
MM/DD/YY		
1	12 /05 /19	Added Drawings
2	--/--/--	...
3	--/--/--	...
4	--/--/--	...
5	--/--/--	...

01

A

Veneer Anchor Spacing

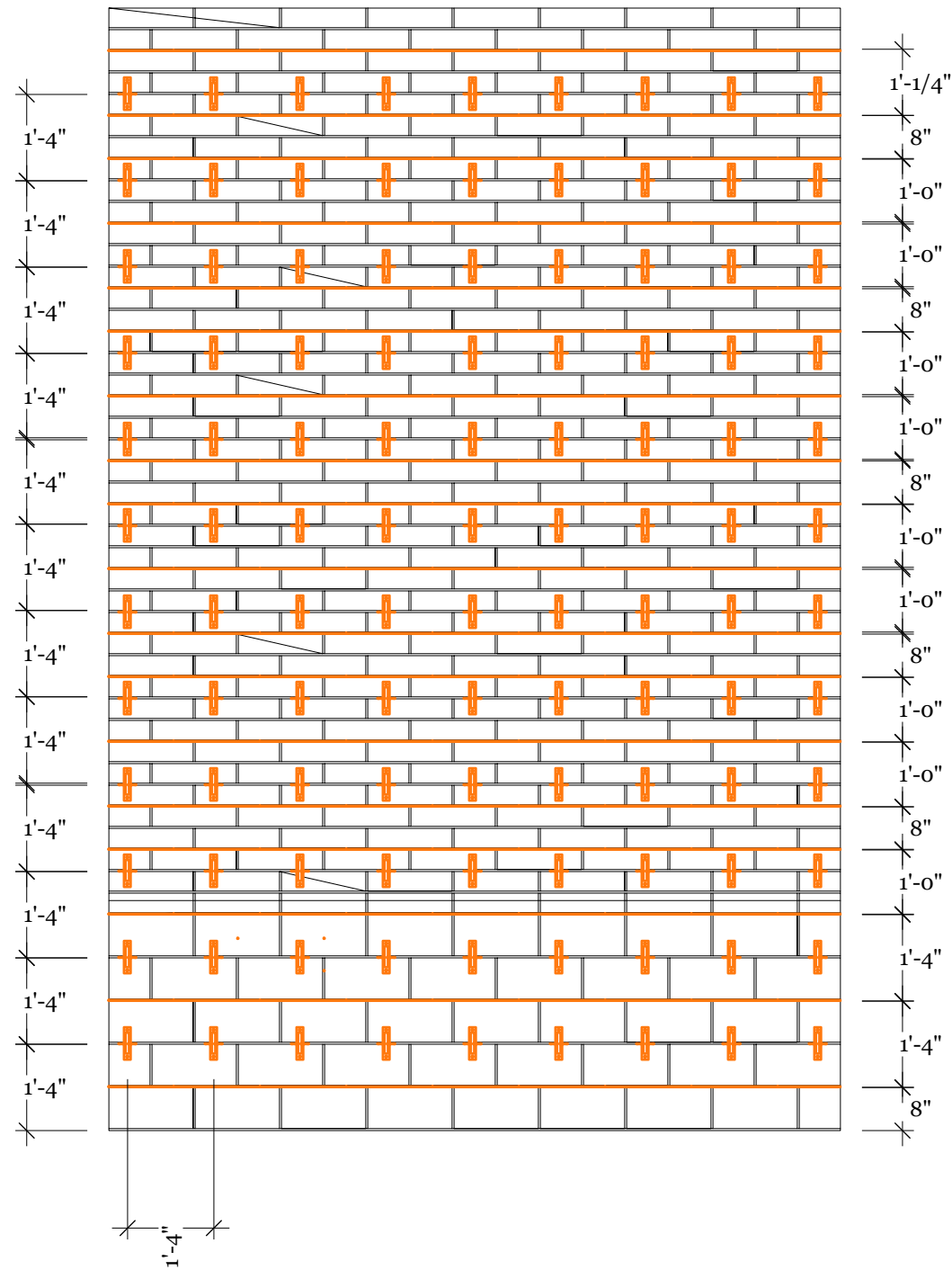

Horizontal Joint Reinforcement Spacing

Spec-Brik (4" high nominal) and Spec-Brik Jumbo (8" high nominal)  
 Anchor Placement: 16"vx16"h  
 HJR Spacing: 12" Max (8" and 12")



Spec-Brik Veneer Details

Drawing No. 7006

REVISIONS

MM/DD/YY	REMARKS
12/05/19	Added Drawings
___/___/___	...
___/___/___	...
___/___/___	...
___/___/___	...

02

A

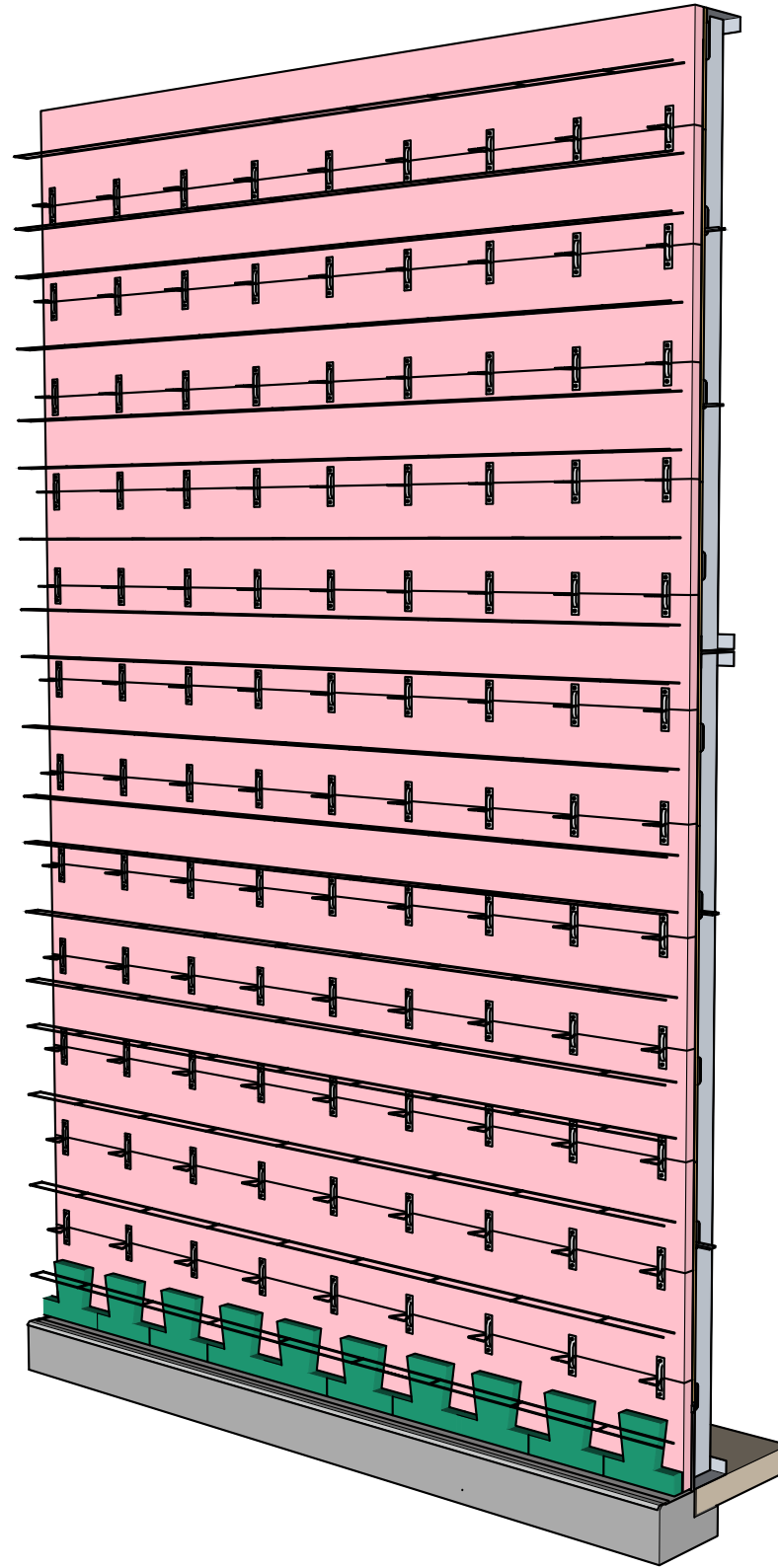

Wall Assembly Shown without Veneer



Spec-Brik Veneer Details

Drawing No. 7006

REVISIONS		
	MM/DD/YY	REMARKS
1	12 /05 /19	Added Drawings
2	--/--/--	...
3	--/--/--	...
4	--/--/--	...
5	--/--/--	...