

# Reinforced Concrete Pipe

Tongue and Groove 15" - 24"

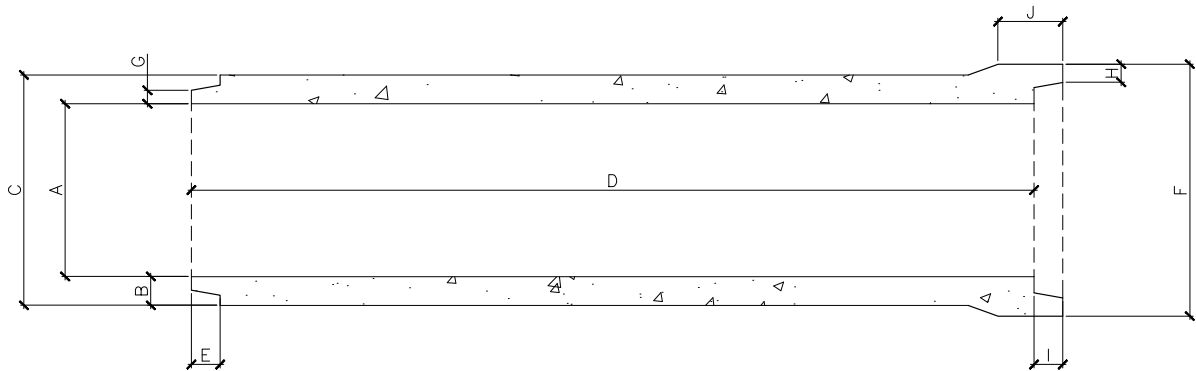
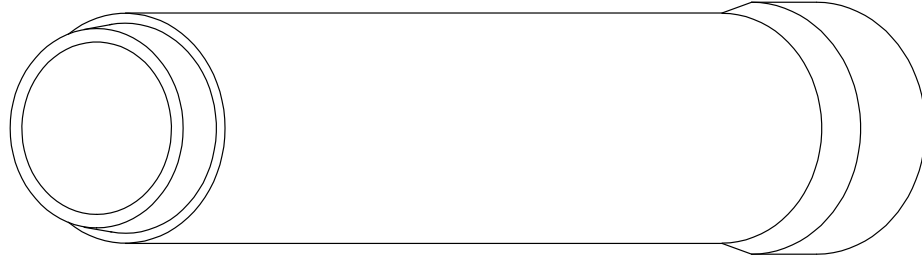

## DIMENSIONS

'A' INSIDE DIAMETER	ASTM WALL	'B' WALL THICKNESS	'C' OUTSIDE DIAMETER	'D' AVAILABLE LENGTHS	'E'	'F'	'G'	'H'	'I'	'J'
15"	B	2.25"	19.50"	8.00'	2"	20½"	7/8"	1¼"	2"	4"
18"	B	2.50"	23.00"	8.00'	1⅞"	24¼"	1"	1¾"	2"	5½"
24"	B	3.00"	30.00"	8.00'	3½"	31¾"	1"	2¼"	2¾"	6"

- Reinforced concrete pipe to be manufactured to meet the following specs:
  - ASTM C76
  - AASHTO M170
  - NCDOT / SCDOT
- Mortar or flexible plastic type joint to meet fed spec SS-S-210A and ASSHTO M-198B
- Reinforced in accordance with applicable standard by wall (B) and Class (III, IV, and V)



Large enough to deliver.  
Small enough to care.  
Since 1947.

[JohnsonProductsUSA.com](http://JohnsonProductsUSA.com)

■ Corporate Headquarters  
Pipe & Drainage Structures  
217 Klumac Road  
Salisbury, NC 28144  
**704.636.5231**

■ Raleigh Area Showroom  
Masonry & Hardscapes  
1401 Hwy 42  
Willow Spring, NC 27592  
**919.552.0233**

■ Triad Area Showroom  
Architectural Masonry & Hardscapes  
514 Burgin Drive  
Lexington, NC 27292  
**336.248.2918**

■ Charlotte Area Showroom  
Masonry & Hardscapes  
106 Old Davidson Place NW  
Concord, NC 28027  
**704.786.4204**

